

ITEM - 1  
BUS BAR PVC INSULATED SHROUD

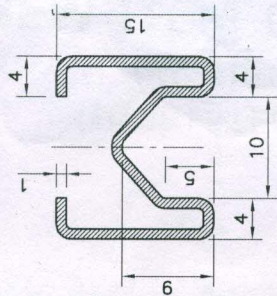

ITEM - 2  
G.I. CONDUCTOR BUS BAR

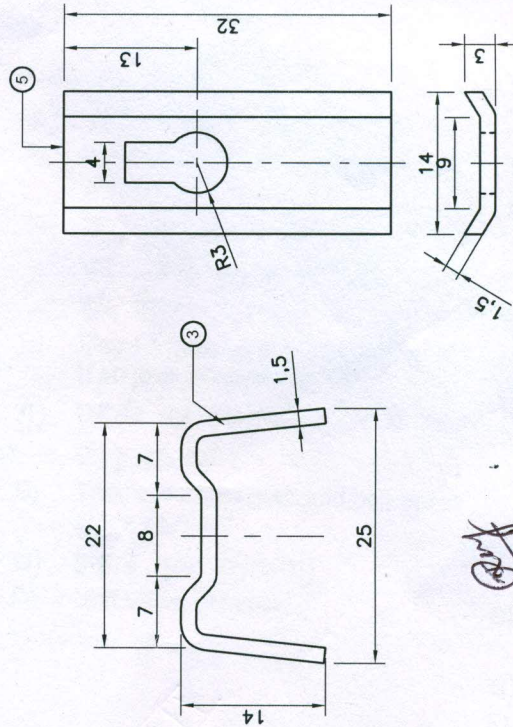

ITEM - 4  
QTY. 2 NOS.  
CONNECTING LINK

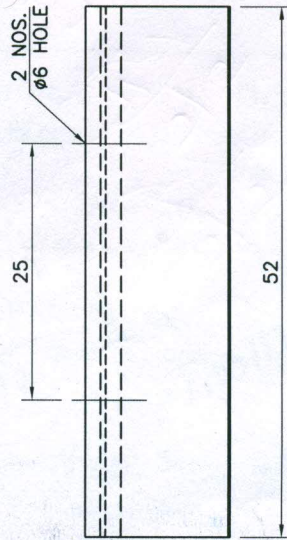

ITEM - 3  
BUS-BAR CONNECTOR

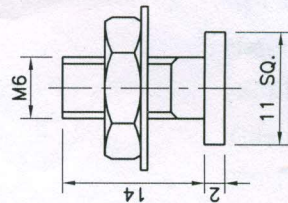

ITEM - 5  
QTY. 2 NOS.  
CONNECTING SCREW

NOTE :- 1) ALL CONNECTING SCREW, CONNECTOR, CONNECTING LINK, CURRENT CARRYING CONDUCTOR

SHALL BE MADE UP OF GALVANISED IRON (G.I.)

2) RATING OF BUS-BAR CONDUCTOR SHALL BE 63/100 AMPS, 440 VAC, 50 Hz.

3) INSULATING SHROUD SHALL BE OF PVC OF 1.1 KV GRADE

4) PVC SHROUD SHALL BE COLOR CODED RED, YELLOW, BLUE AND GREEN

5) TOTAL LENGTH OF DSL BUS-BAR SHALL BE 4500 mm



URANIUM CORPORATION OF INDIA LTD, TURAMDIH MILL  
(A GOVT. OF INDIA ENTERPRISE, DEPT. OF ATOMIC ENERGY)

DRN. Rajesh 27.09.17 TITLE

CHECKED J.ROY

APPROVED G. DHAR

SCALE - NTS

DIMENSIONS IN MM

SHROUDED DSL BUS BAR FOR  
EOT CRANE

DRG.NO.- MILL/TMD/ELECT.- 141 REV.- 0